



ESCALADE

FIFTH WHEELS BY KZ



9270 WEST U.S. 20
SHIPSHEWANA, IN, 46565
PH: 260-768-4016
WWW.KZ-RV.COM

Due to continual research and advances, manufacturer reserves the right to change specifications, design, price and equipment without notice, and assumes no responsibility for any error in this literature. Some items shown are not included as standard or optional equipment. 2006 K-Z

Dealer:

ESCALADE

FIFTH WHEELS BY 

LIVING ROOM





TRAVEL THE HIGH ROAD OF FINE RV LIVING WITH ESCALADE. THESE LUXURY FIFTH WHEELS ARE DESIGNED WITH A UNIQUE BLEND OF PRACTICALITY AND ELEGANCE, RESULTING IN THE MOST BEAUTIFULLY LIVABLE TRAVEL HOME YOU'LL EVER FIND. FROM LAVISH LIVING AREAS TO WELL APPOINTED KITCHENS, THE ESCALADE CREATES THE KIND OF RV LIFE YOU DESERVE.

▲ 37 REB FLOOR PLAN SHOWN WITH CASHMERE DECOR, CHERRY CABINETRY AND OPTIONAL 40" LCD TV

revelations of beauty

KITCHEN

sublime design

▲ 37 REB FLOOR PLAN SHOWN WITH CASHMERE DECOR AND CHERRY CABINETRY





▲ 37 KSB FLOOR PLAN SHOWN WITH CASHMERE DECOR AND MAPLE CABINETRY

► CORIAN® RECESSED SINK COVERS ADD FUNCTIONALITY TO THE KITCHEN.

The Escalade is adorned with all the amenities of home!

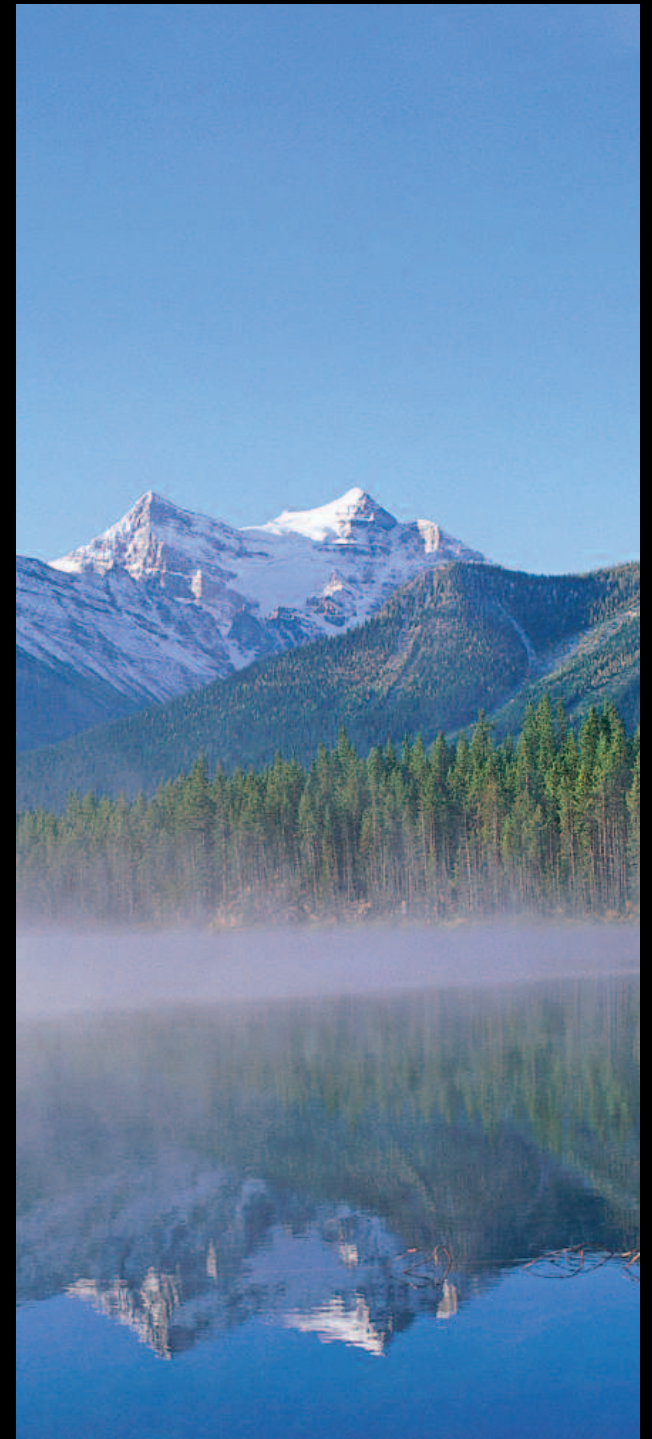

ESCALADE

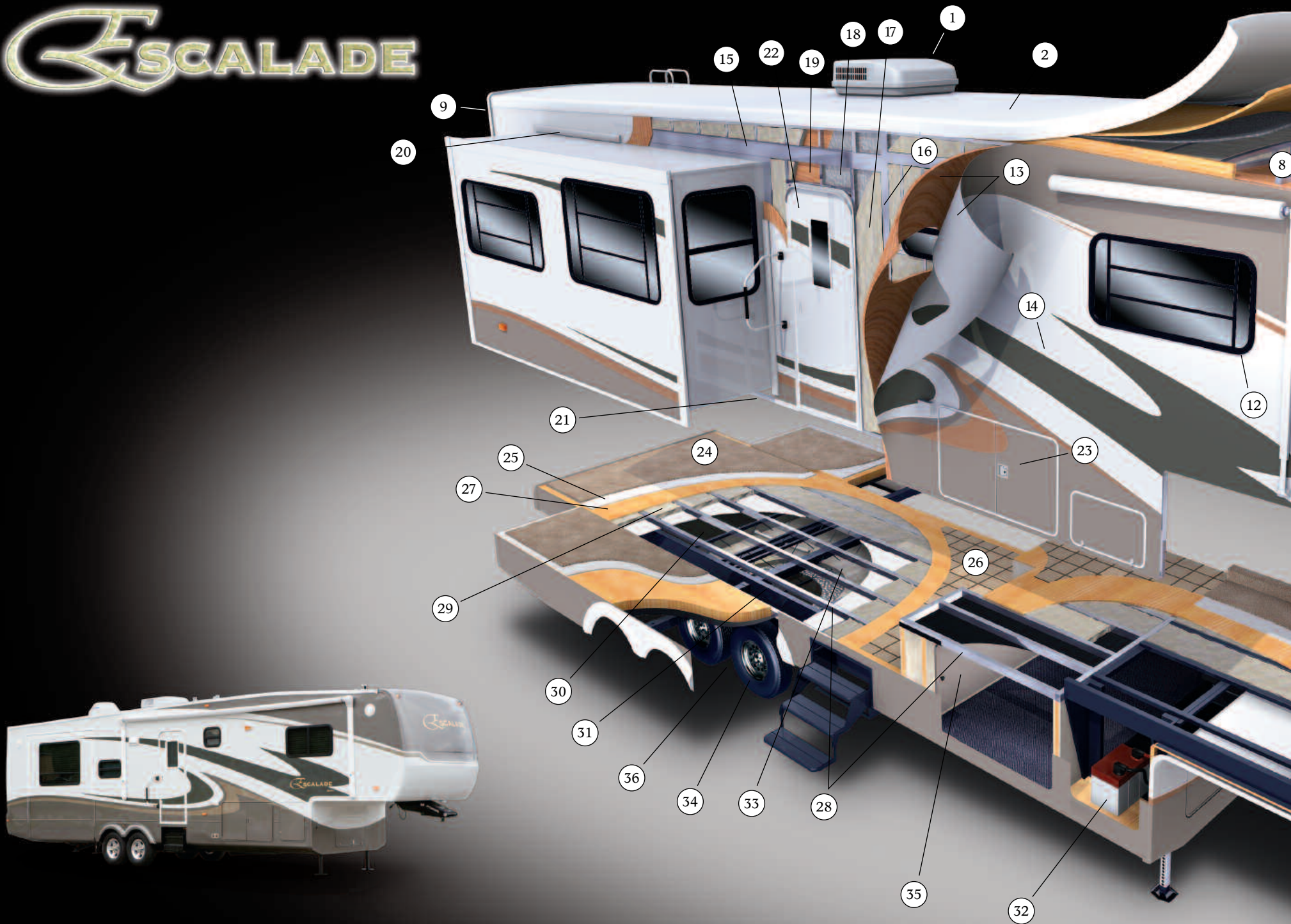



CUT-A-WAY HIGHLIGHT FEATURES

1. 15K low profile A/C
2. One piece seamless Royal Tuff-Ply roof
3. 1/2" plywood roof decking
4. R-7 Flex foil insulation
5. R-14 fiberglass batten insulation (total roof R-21)
6. 5-3/4" aluminum truss rafters - 16" O.C.
7. Soft touch vinyl ceiling with luan backing
8. Insulated ductwork
9. One piece gel coat fiberglass cap-front and rear. One piece fiberglass undercap
10. Exterior security lights
11. Eclipse electric awning
12. Tinted safety glass windows
13. Gel coat fiberglass exterior with integrated luan backing
14. Premium exterior paint package with raised Escalade logo
15. Heavy-duty aluminum headers
16. 2" x 2" aluminum double welded wall studs - 16" O.C.
17. R-7 fiberglass batten wall insulation
18. R-7 Flex foil (walls total R-14)
19. Decorative luan interior wall board
20. Triple seal flush mount slide-out
21. Rack and pinion electric slide with manual override and 3" x 3" box tube slide-out ram
22. 30" entry door
23. Large capacity pass-through storage with split access doors
24. High grade residential carpet
25. Residential style carpet pad
26. Armstrong linoleum
27. 5/8" tongue and groove plywood floor decking
28. 2" x 3" aluminum double welded floor joists - 16" O.C.
29. R-14 fiberglass batten insulation
R-7 fiberglass batten insulation in sub-floor
R-7 Flex foil insulation (total floor R-28)
30. Darco moisture barrier
31. Strong welded frame structure. 18" total height (10" "I" beam and 8" "box" beam)
32. Easy access exterior battery compartment
33. Fully enclosed underside
34. Heavy-duty 16" 8 lug wheels, 7000# axles with easy lube hubs
35. Easy access to the furnace, converter, water pump, and other mechanical items
36. MOR/ryde suspension

BEDROOM AND BATHROOM



▲ 37 REB FLOOR PLAN SHOWN WITH CASHMERE DECOR AND CHERRY CABINETRY

extravagant comfort



▲ LARGE CORNER SHOWER WITH SLIDING GLASS DOOR IS A STANDARD BATHROOM FEATURE.

*relaxation
at its best!*



▲ HANDSOME OVERHEAD BEDROOM CABINET HOLDS A 20" LCD TV.



▲ 36 KSB FLOOR PLAN SHOWN WITH CASHMERE DECOR AND MAPLE CABINETRY

EXTERIOR FEATURES



LARGE EXTERIOR STORAGE COMPARTMENT INCLUDES HANDY ACCESS DOOR TO THE FURNACE AND VACUUM SYSTEM. SHOWN WITH OPTIONAL ROLL-OUT TRAY.



THE EXTERIOR WATER HOOK-UP CENTER INCLUDES AN OUTSIDE SHOWER FOR CONVENIENCE.



HEAVY-DUTY 7000# AXLES INCLUDE MOR/RYDE SUSPENSION.

FLOOR PLANS

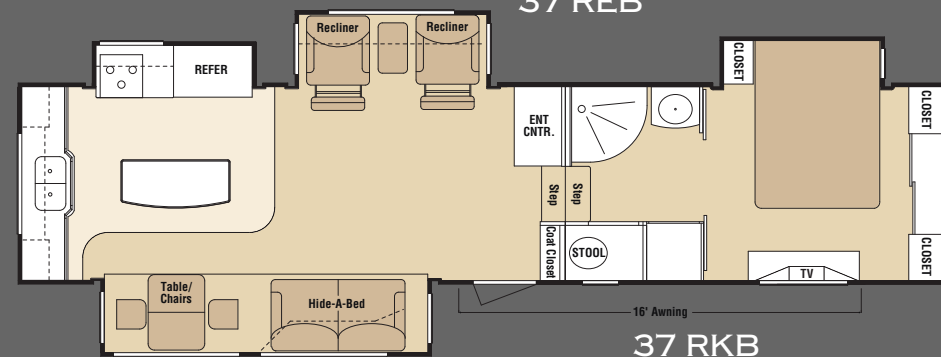
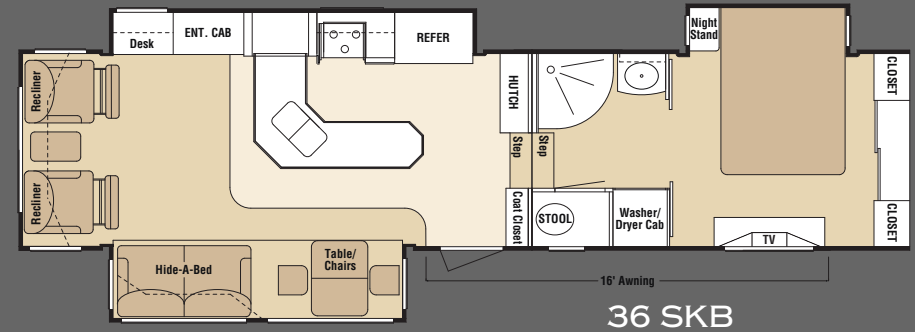
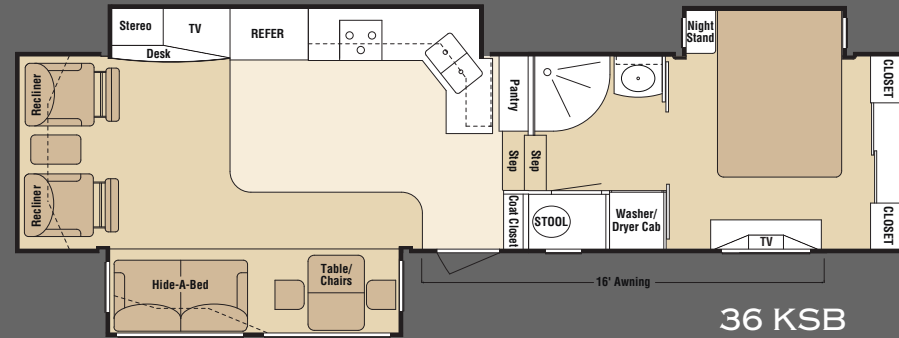

SPECIFICATIONS AND FEATURES

Escalade	36 KSB	36 SKB	37 REB	37 RKB
UVW (Unloaded Vehicle Weight)	13525	13390	13390	14000
Dry Hitch Weight	2435	2155	1925	2065
Dry Axle Weight	11090	11235	11465	11935
NCC (Net Carrier Capacity)	3275	3410	3410	2800
GVWR	16800	16800	16800	16800
Interior Height	93"	93"	93"	93"
Exterior Width	96"	96"	96"	96"
Exterior Length	38' 4"	38' 4"	39' 8"	39' 8"
Exterior Height with A/C	151"	151"	151"	151"
Fresh Water Capacity (gal)	55	55	55	55
Waste Water Capacity (gal)	50	50	50	50
Grey Water Capacity (gal)	88	50	88	88
Water Heater Capacity (gal – G/E w/DSI)	12	12	12	12
LP Gas Capacity (lbs.)	80	80	80	80
Furnace BTUs	42	42	42	42
Tire Size (G-Rated)	LT235-85R16	LT235-85R16	LT235-85R16	LT235-85R16
Axle Rating	(2) 7000	(2) 7000	(2) 7000	(2) 7000

AVAILABLE OPTIONS

- Fireplace
- 2nd 13.5 A/C in Bedroom
- Heat Pump Upgrade
- Convection Microwave
- Ice Maker (with Water Dispenser in Door)
- King Size Bed
- Infinity Ceiling Light
- 40" LCD TV Upgrade (N/A in 37RKB)
- Door Bell
- Island Kitchen (36KSB Only)
- CSA (Canadian Required)
- Generator Prep
- Onan 5.5 Generator
- Disc Brakes
- Atwood Leveling System
- Thermopane Windows
- Automatic Satellite
- Power Cord Reel
- 5th Airborne Hitch
- Slide Out Covers
- Slide Out Patio Awning
- Wind Sensor
- Roll-Out Tray
- 2nd Battery



STANDARD INTERIOR FEATURES

- Wood Color Choices: Solid Maple or Solid Cherry
- Solid Wood Cabinets - Cathedral Style Doors (All cabinets pre-drilled and screwed)
- Corian® Countertops
- Corian® Recessed Sink and Stove Covers
- Day-Night Shades
- 12 Cu. Side x Side Refer with Stainless Steel Front
- Residential Stainless Steel Microwave
- Soft Touch Padded Ceiling
- Water Filter
- Concealed Residential Style Hinges
- Mirrored Entry Closet with Grandfather Clock
- Wired for Automatic Satellite System
- Back-Lit Entry Switches
- Overhead Ceiling Fan
- Skylight in Shower
- 27" Sony® TV
- Sony® Stackable Stereo with Full Surround Sound
- Sony® DVD Player
- Hide-A-Bed Sofa

- Leather Recliners
- Window Treatment with Swag Curtains
- Solid Wood Inside Assist Handle
- Waste Basket
- 22" Broiler Oven - Stainless Steel Front
- Swing-Up Coffee Table
- Electrical Command Center
- "Flex Comfort" Bed Spring
- Large Corner Shower with Sliding Glass Doors
- 20" Flat Screen TV in Bedroom
- Washer/Dryer Ready

- Large Closets with Dressing Mirrors
- 80" Pillowtop Mattress
- Plush Bedspread with Pillow Shams
- Fluorescent and Residential Lighting
- Free Standing Table with Leaf and 4 Chairs
- Porcelain Toilet with Sprayer
- Dirt Devil® Central Vacuum with Built-In Dust Pan
- Prep for 2nd A/C in Bedroom
- 42,000 BTU Furnace

STANDARD EXTERIOR FEATURES

- All Aluminum Double Welded Cage Frame
- Gel Coat High Gloss Fiberglass Sidewalls
- Hi-Quality Painted Exterior Graphics
- Heavy Duty Aluminum Wheels
- Roof Ladder
- 18" Main Frame
- 4 Security Lights
- Split Trunk Doors for Easy Access
- Power Eclipse Awning
- 2 40lb. LP Bottles
- 16" "G" Rated Tires
- Independent Power Front Jacks with Snap Pins
- 7000# Axles with MOR/ryde Suspension
- 12 Gal. Gas/Electric DSI Water Heater
- 50 Amp Service (65 Amp Converter)
- Fold Out Entry Grab Handle
- 30" Entry Door
- TV Antenna
- Satellite Prep
- 5/8" Tongue and Groove Plywood Floor
- Black Tank Flush System
- Extended Pin Box
- Enclosed Underbelly
- Heated Holding Tanks
- Tinted Windows with Safety Glass
- Exterior Shower
- Exterior Water Hook Up Center
- Entry Step and Porch Lights
- Low Profile Ducted 15,000 BTU A/C
- Spare Tire and Hoist
- Rear Power Stabilizer Jacks
- 1/2" Plywood Roof Decking

DÉCORS

